

**B** LEDGER FASTENING DETAIL  
**A3** 1 1/2" = 1 FOOT

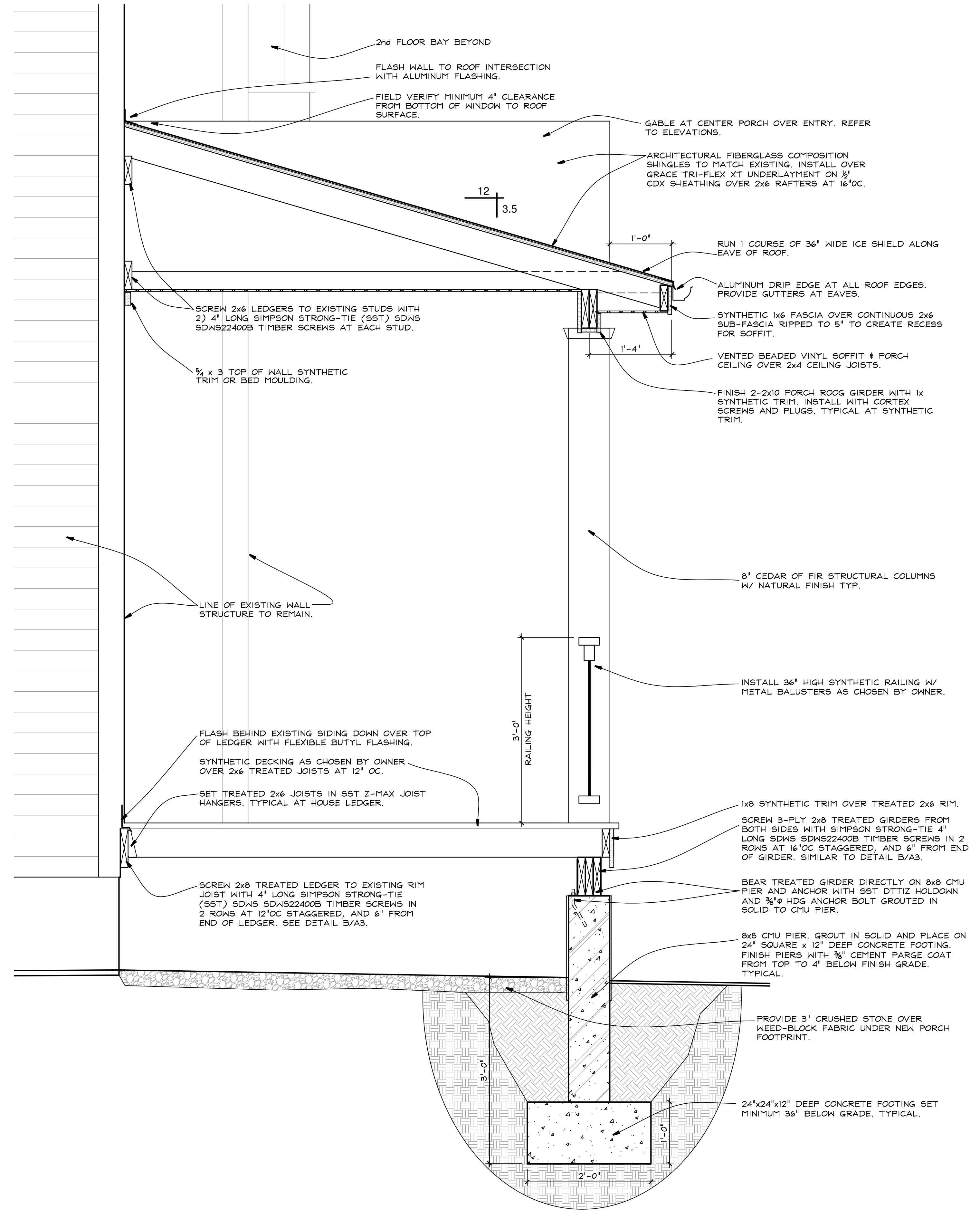

**A** PORCH SECTION  
**A3** 1" = 1 FOOT

**ROHLWING PORCH**  
 23 West End Avenue  
 Upper Nyack, N.Y. 10960

**KIER B. LEVESQUE, R.A.**  
 ARCHITECT  
 49 THIRD AVENUE  
 NYACK, NEW YORK 10960  
 845-358-2359

**DETAILS & SECTION**

SCALE AS SHOWN  
 DATE JULY 31, 2023  
 JOB NO. 202312  
 REVISIONS: SHEET NO.

**A-3**

NY LICENSE # 15938